



luxury
flush
door

home elevators by



The Ideal Code-Compliant Swing Door Solution

Adding a landing door for your Garaventa Lift home elevator is now easier than ever with this high quality solid, flush door. Available in 3 standard sizes (36" x 80", 36" x 84" and 36" x 96"), the Garaventa Lift Luxury Flush Door meets the ASME A17.1 – 2022 - Safety Code for Elevators and Escalators, limiting the potential for entrapments between the hall door and the elevator door/gate, providing you with a safe installation.

With handy tuck-in channels, the aluminum frame provides seamless edges with drywall. The safety interlock device is completely concealed, as are the hidden hinges, creating a clean look. A flush pull handle and a safety release on the hoistway side of the door make for easy closing and emergency evacuation when required. The Garaventa Lift Luxury Flush Door delivers a safe and beautiful landing door for the Garaventa Lift Elvoro HR/MR home elevators.

Luxury Flush Door Features

- 1 Solid slab* 1.75" (44 mm) thickness with stability strength, paint grade finish
- 2 Option to add hall station to the frame
- 3 Add your own exterior hardware to match home
- 4 Integrated pocket in frame accommodates 1/2" drywall for seamless edges
- 5 Concealed hinges for a clean look
- 6 Low profile, white painted aluminum frame, can be custom painted on site
- 7 Completely concealed electric Kronenberg interlock, exclusive for North America
- 8 Sleek interior door hardware provides pull-to-open with emergency release mechanism

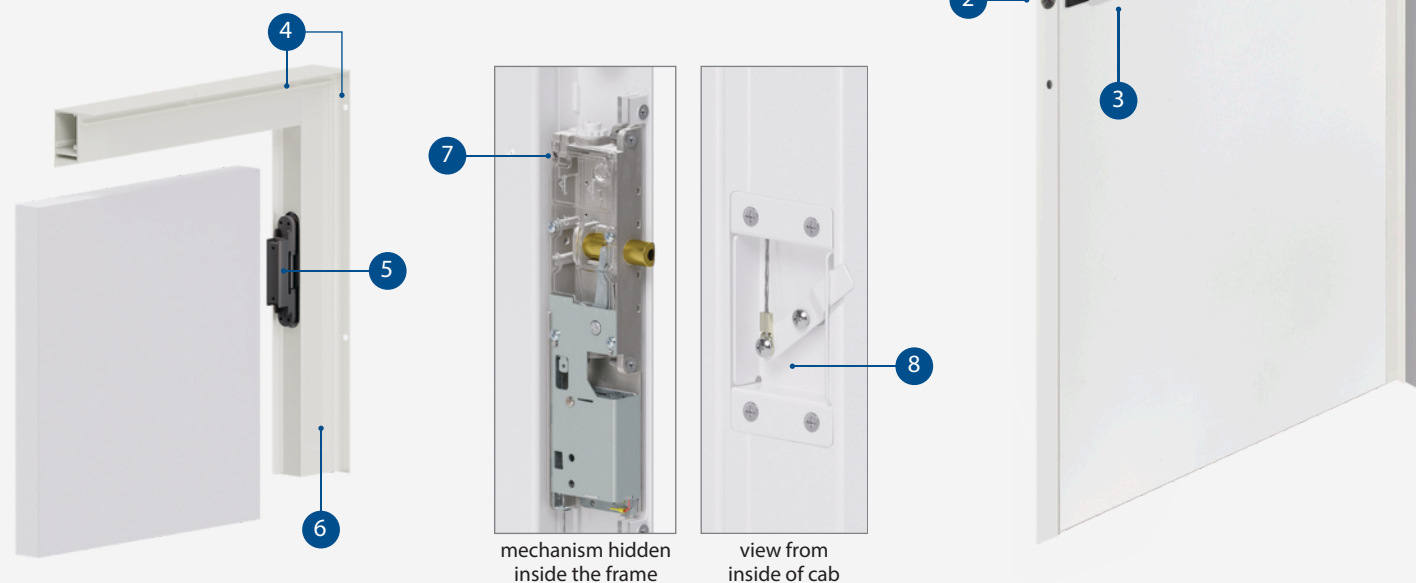

FRAME ONLY OPTION AVAILABLE

Supply your own door slab to match other doors in your home for a cohesive look.

All Garaventa Lift home elevators in North America require a cab gate / door. See our website for information about cab entrances.

Locate a Garaventa Lift home elevator dealer near you
1.800.663.6556

AVAILABLE DOOR SIZES (opening from inside)

Minimum clear opening 34.25"

36" x 80" (914.4 mm x 2032 mm)

36" x 84" (914.4 mm x 2133.6 mm)

36" x 96" (914.4 mm x 2438.4 mm)

Standard: ANSI/WDMA I.S. 1A – 2013 ; CAN/CSA 0132.2 Series-90(R1998) AWI/AWMAC WI 2nd Edition (2014)

*core is medium density particle board 28-32 lb/ft³